

LFRP Serie Messing- Verbinder für Trinkwasser, Lebensmittel und Getränke

M A D E I N I T A L Y

 **TierreFittings**[®]

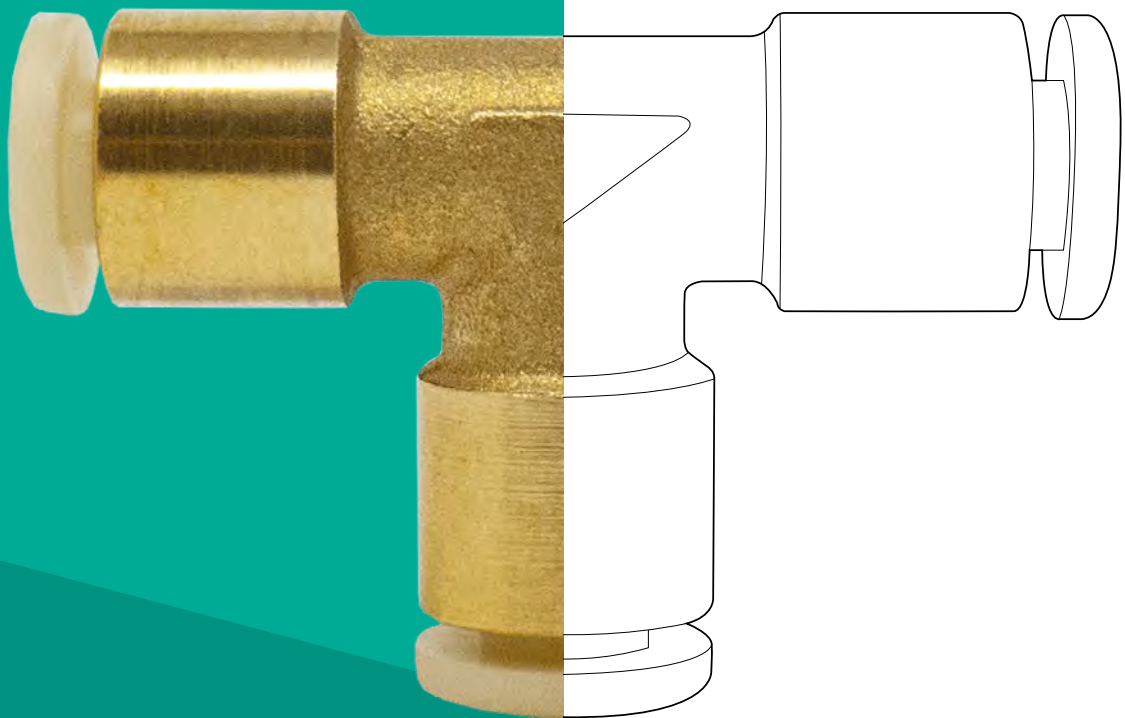

25
anniversary

 **TierreGroup**[®]
Unique vision

Lebensmittel und Getränke LFRP Serie



PLUS

**Materialien verwendbar mit
Lebensmitteln, Getränken und
Trinkwasser**

**Konstruktion garantiert
höchste Zuverlässigkeit und
mechanische Stabilität**

**Speziell für den Einsatz in
Kaffemaschinen und
Verkaufsautomaten**

**Gehäuse aus unbeschich-
tetem Messing CW510L mit
maximalem Bleigehalt von
0,1% ohne Ausnahme**

**EPDM PEROX Dichtungen
widerstandsfähig gegen
Dampf und dauerhaft
hohen Temperaturen**

**Kundenindividuelle
Varianten auf Anfrage**

M A D E I N I T A L Y



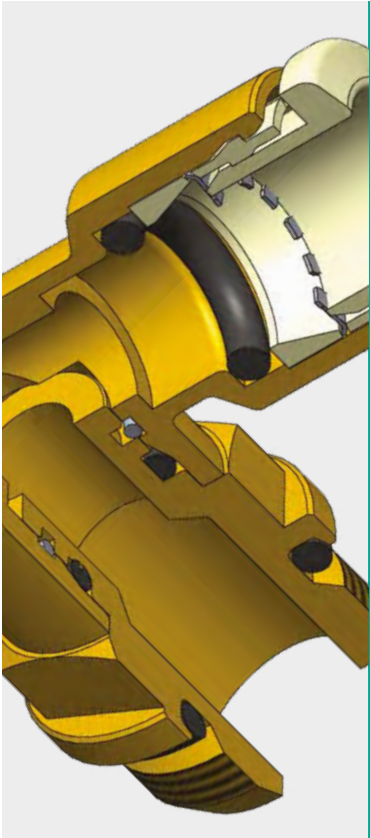



 -20 °C ÷ 150 °C

 Arbeitsdruck:
20 Bar
Negativdruck:
-0,95 Bar (- 95 Kpa)

 Druckluft, Vakuum, Wasser
(Trinkwasser) sowie
Getränke und Lebensmittel

 Parallelgewinde BSPP ISO
228 G1/8 - G3/8 Zoll
sowie metrisches Gewinde
ISO 262 M5

 Polyamid PA, Polyethylen PE,
FEP und PTFE

Gehäuse: unbeschichtetes Messing CW510L (max. 0,1% Blei ohne Ausnahmen)konform NSF/ANSI 372

Halteelement: Hochleistungspolymer

Haltekragen: Hochleistungspolymer

Haltezähne: Edelstahl AISI 301

Innenring: Hochleistungspolymer

Innendichtung: EPDM PEROX in Übereinstimmung mit allen wesentlichen Standard für Lebensmittel und Trinkwasser

O-Ring: EPDM PEROX in Übereinstimmung mit allen wesentlichen Standard für Lebensmittel und Trinkwasser

Haltering Schwenksystem: Edelstahl AISI 302

BLEIFREI

Die Steckverbinder entsprechen den Anforderungen des maximalen Bleigehalts von Sanitärsystemen „BLEIFREI“ nach dem U.S. Safe Drinking Water Act.



NSF/ANSI 169



EC 1935/2004 Materialien mit Lebensmittelkontakt



D.M. 174/2004



ICIM Zertifizierung Produkt für Lebensmittelkontakt



ICIM Zertifizierung für Wasserkontakt

SILICONE FREE



Produktkonformität mit Richtlinie 1907/2006

RoHS3
NO EXCEPTIONS

Maximaler Bleigehalt 0.1% ohne Ausnahmen in Übereinstimmung mit EU-Richtlinie 2015/863

Aufbau der Steckverbinder

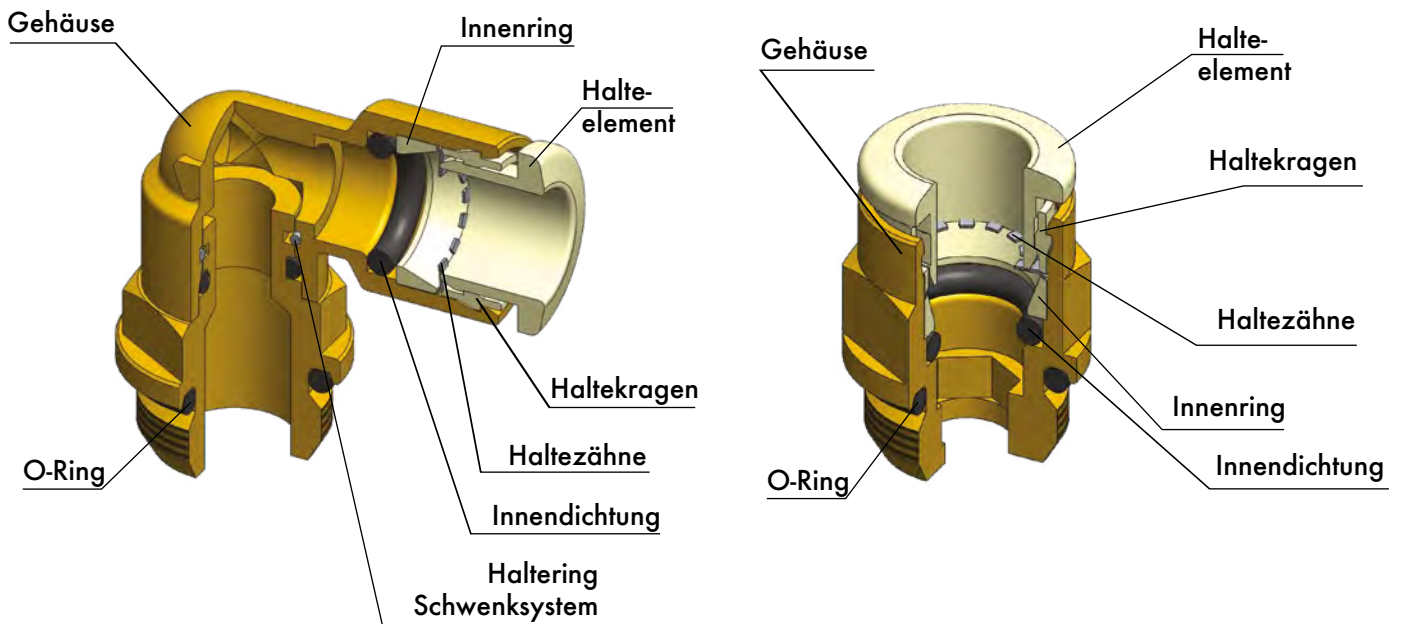

Einstecken des Schlauchs in den Steckverbinder

Zum Einstecken des Schlauchs in den Steckverbinder muss der Schlauch sauber und ordentlich rechtwinklig 90° abgeschnitten werden, so dass eine gerade Schnittkante entsteht. Der Schlauch muss dann vorsichtig mit leichtem Druck bis zum Endanschlag in den Steckverbinder eingesteckt werden.

Danach sollte der eingesteckte Schlauch wieder ein Stück vorsichtig zurückgezogen werden. Dadurch wird geprüft, ob der Schlauch fest im Steckverbinder sitzt. Durch ein weiteres leichtes Nachdrücken des Schlauchs in den Steckverbinder wird sichergestellt, dass der Schlauch vollständig in den Verbinder eingesteckt ist.

Bei beschädigter oder zerkratztter Oberfläche des Schlauchs, kann es zu Leckagen oder unbeabsichtigtem Lösen des Schlauchs kommen. Der Zustand der Schlauchoberfläche sollte vor dem Einstecken sorgfältig überprüft werden.

Bei Ausüben von Druck dehnt sich der Außendurchmesser von Polyurethanschläuchen. Diese Ausdehnung kann außerhalb der Toleranz liegen. Ein erneutes Einsetzen in den Steckverbinder ist möglicherweise nicht immer möglich.

Herausziehen des Schlauchs aus dem Steckverbinder

Das System sollte drucklos sein, bevor der Schlauch aus dem Steckverbinder gezogen wird.

Zum Lösen des Schlauchs wird der Haltekragen des Steckverbinders nach unten gedrückt gehalten (1) und mit der anderen Hand der Schlauch aus dem Steckverbinder gezogen (2).

Zum erneuten Einstecken des Schlauchs sollte dieser mit einem Schlauchschnneider neu abgeschnitten werden.

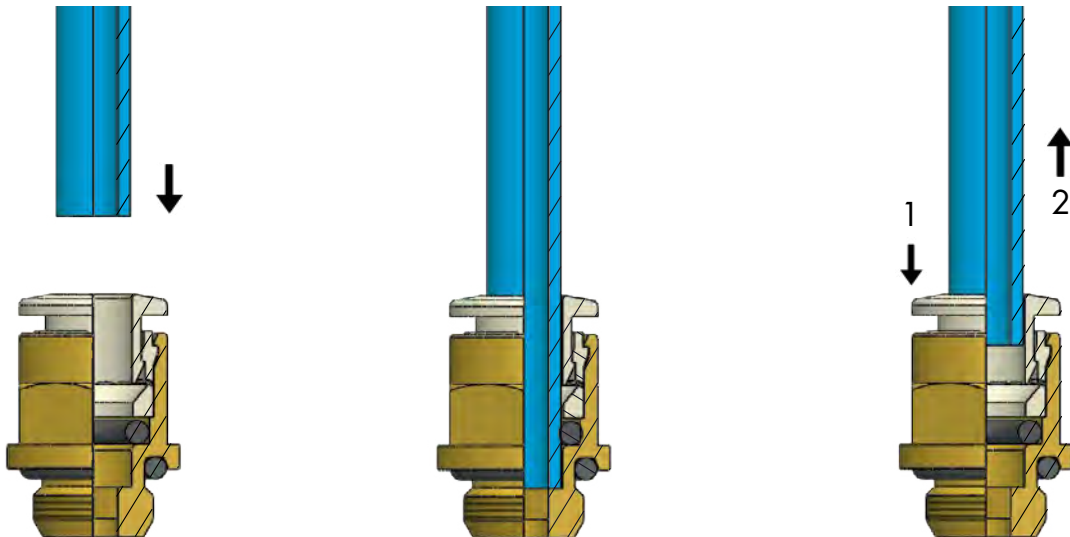

Toleranzen metrischer Schlauch

Ø Schlauch AD (mm)	4	6	8
Toleranz (mm)	± 0,1	± 0,1	± 0,1

Einstecktiefe metrischer Schlauch

Ø Schlauch AD (mm)	4	6	8
Einstecktiefe Schlauch (mm)	14	15,5	17,5

Maximale Drehmoment-Werte

Parallelgewinde BSP ISO228 & metrisch ISO 262

Gewinde	M5x0,8	1/8"	1/4"	3/8"
Nm	1 ± 20%	6 ± 20%	7,5 ± 20%	9 ± 20%



LFRPC-G

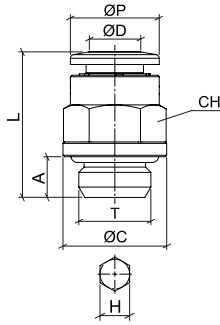

Einschraubverbinder BSPP Parallelgewinde & metrisch M5

CODE	ØD	T	ØP	ØC	A	L	CH	H
LFRPC04M5	4	M5x0,8	10	7	4	19,0	9	2,5
LFRPC04G01		G 1/8"	10	14	5,5	18,0	10	3
LFRPC06M5	6	M5x0,8	12	7	4	21,0	11	2,5
LFRPC06G01		G 1/8"	12	14	5,5	19,5	12	4
LFRPC06G02		G 1/4"	12	16	6,5	19,5	12	4
LFRPC08G01	8	G 1/8"	14	14	5,5	24,5	14	5
LFRPC08G02		G 1/4"	14	16	6,5	21,5	14	6
LFRPC08G03		G 3/8"	14	20	7,5	21,5	14	6

LFRPCF-G

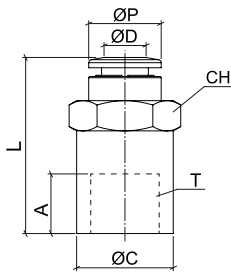

Aufschraubverbinder BSPP-Parallelgewinde

CODE	ØD	T	ØP	ØC	A	L	CH
LFRPCF04G01	4	G 1/8"	10	13	7,5	24,5	10
LFRPCF06G01	6	G 1/8"	12	13	7,5	26,0	12
LFRPCF06G02		G 1/4"	12	16	11	29,5	12
LFRPCF08G02	8	G 1/4"	14	16	11	32,0	14
LFRPCF08G03		G 3/8"	14	20	12	32,0	14

LFRPL-G

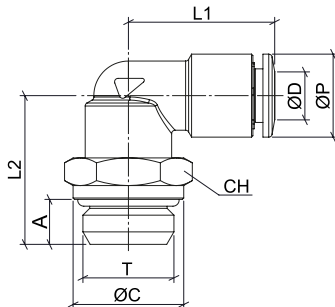

Winkel-Einschraubverbinder drehbar BSPP-Parallelgewinde

CODE	ØD	T	ØP	ØC	A	L1	L2	CH
LFRPLO4M5	4	M5x0,8	10	7	4	18,0	15,0	8
LFRPLO4G01		G 1/8"	10	13	5,5	19,5	19,0	13
LFRPLO6M5	6	M5x0,8	12	7	4	19,5	16,0	8
LFRPLO6G01		G 1/8"	12	13	5,5	21,0	19,0	13
LFRPLO6G02		G 1/4"	12	16	6,5	21,0	21,5	13
LFRPLO6G03		G 3/8"	12	20	7,5	21,0	23,0	13
LFRPLO8G01	8	G 1/8"	14	13	5,5	23,0	19,0	13
LFRPLO8G02		G 1/4"	14	16	6,5	23,0	21,5	13
LFRPLO8G03		G 3/8"	14	20	7,5	23,0	23,0	13



LFRPT-G

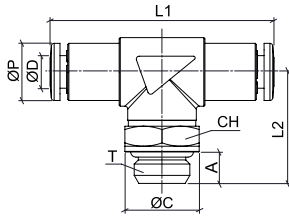

T-Einschraubverbinder drehbar BSPP-Parallelgewinde

CODE	ØD	T	ØP	ØC	A	L1	L2	CH
LFRPT04G01	4	G 1/8"	10	13	5,5	39,0	19,5	13
LFRPT06G01	6	G 1/8"	12	13	5,5	42,0	19,5	13
LFRPT06G02		G 1/4"	12	16	6,5	42,0	22,0	13
LFRPT08G01	8	G 1/8"	14	13	5,5	46,5	19,5	13
LFRPT08G02		G 1/4"	14	16	6,5	46,5	22,0	13
LFRPT08G03		G 3/8"	14	20	7,5	46,5	23,5	13

LFRPUC

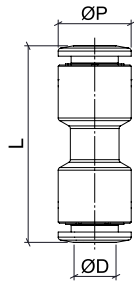

Gerader Verbinder

CODE	ØD	ØP	L
LFRPUC04	4	10	29,0
LFRPUC06	6	12	32,0
LFRPUC08	8	14	36,0

LFRPUL

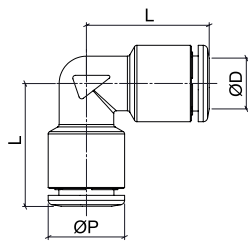

Winkel-Verbinder

CODE	ØD	ØP	L
LFRPUL04	4	10	18,0
LFRPUL06	6	12	19,5
LFRPUL08	8	14	22,5

LFRPUT

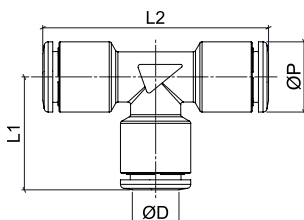

T-Verbinder

CODE	ØD	ØP	L1	L2
LFRPUT04	4	10	18,0	36,0
LFRPUT06	6	12	19,5	39,0
LFRPUT08	8	14	22,5	45,5



NSF-Zertifizierung

NSF International

789 N. Dixboro Road, Ann Arbor, MI 48105 USA

RECOGNIZES

Tierre Group S.p.A.
Italy

AS COMPLYING WITH NSF/ANSI 169 AND ALL APPLICABLE REQUIREMENTS.
PRODUCTS APPEARING IN THE NSF OFFICIAL LISTING ARE
AUTHORIZED TO BEAR THE NSF MARK.



ISO/IEC 17065
Product Certification Body
#2218

Certification Program
Accredited by the
American National
Standards Institute



Certification Program
Accredited by the
Standards Council
of Canada

This certificate is the property of NSF International and must be returned upon request. This certificate remains valid as long as this client has products in NSF's Official Listings for the referenced standards. For the most current and complete Listing information, please access NSF's website (www.nsf.org).

July 10, 2019
Certificate# C0484626 - 01

A handwritten signature in black ink, appearing to read "S. Krol", written over a horizontal line.

Sarah Krol
Global Managing Director, Food Safety Product Certification



Zertifizierung für Materialien mit Lebensmittelkontakt - EC 1935/2004*

* Die vollständigen Zertifizierungsnachweise können auf Anfrage zugesandt werden.



Tierre Group S.p.a.
 Headquarter: Via Dell'Industria 18 – 20032 Cornano (MI) – Italy
 Warehouse: Via Dell'Artigianato 2 – 20032 Cornano (MI) – Italy
 Production: Via Marco Blagi 1 – 25045 Castegnato (BS) – Italy
 C.F. e P.IVA IT 12437570158 – Capital €120.000,00 i.v.
 REA MI-1558390

Phone: +39 02 663088.1 – Fax +39 02 66304172
 www.tierregroup.com – info@tierregroup.com

DECLARATION OF CONFORMITY

FCMs
Food Contact Materials



TIERRE GROUP S.p.a.
DECLARES

That the items related to the following product range

BRASS PUSH-IN FITTINGS BRASS CW510L
LFR(P) SERIES

items produced with the following materials
 Brass CW615 L brass - UNI EN 12164 CW 617 N brass
 Viton - EPDM (option)
 AISI 302 Stainless Steel - AISI 301 Stainless Steel

ARE IN COMPLIANCE WITH

To the following General Community Legislation:

EC 1935/2004 regulation of the European Parliament and of the Council dated 27th October 2004 on materials and articles intended to come into contact with food and abrogating the Directives 80/590/EEC and 89/109/EEC.
 Commission Regulation **EC 2023/2006** dated 22nd December 2006 on good manufacturing practice for materials and articles intended to come into contact with food.
 Commission Regulation **EU 2020/1245** dated 2nd September 2020, on plastic materials and articles intended to come into contact with food.

To the following General National Legislation:

Art. 1, art. 3, art 4 paragraph 5, art. 6 of the Presidential Decree dated 23rd August 1982, No. 777, Implementation of the Directive (EEC) No. 76/893 and subsequent amendments, starting from the entry into force of the Legislative Decree dated 10th February 2017, No. 29, Sanctioning discipline for the violation of the provisions as listed in the CE regulations regarding materials and objects intended to come into contact with food products and food in general.

To the following Specific National Legislation:

Ministerial Decree No. 34 dated 21st March 1973, Hygienic regulations for packaging, containers, utensils intended to come into contact with food substances or substances for personal use and subsequent updates and modifications.

These materials are in compliance with the applicable community and national regulations concerning materials and articles intended to come into contact with food. Consequently, the products meet the requirements of the European Regulations and National Legislation as listed above.



D.M. 174/2004 Zertifizierung

* Die vollständigen Zertifizierungsnachweise können auf Anfrage zugesandt werden.



Tierre Group S.p.a.
 Headquarter: Via Dell'Industria 18 – 20032 Cornano (MI) – Italy
 Warehouse: Via Dell'Artigianato 2 – 20032 Cornano (MI) – Italy
 Production: Via Marco Biagi 1 – 25045 Castegnato (BS) – Italy
 C.F. e P.IVA IT 12437570158 – Capital €120,000,00
 REA MI-1558390

Phone: +39 02 663088.1 – Fax +39 02 66304172
 www.tierregroup.com – info@tierregroup.com

**DECLARATION OF CONFORMITY
 D.M. 174/2004**



Regulation concerning materials and objects intended to be used in fixed systems for the collection, treatment, adduction and distribution of water for human consumption.

**TIERRE GROUP S.p.a.
 DECLARES**

that the items related to the following product range

**PUSH-IN FITTINGS
 LFR(P) SERIES**

items produced with the following materials
 UNI EN 12164 CW510 L brass - AISI 316L Stainless Steel - AISI 302 Stainless Steel
 PVDF UHM - EPDM Perox

ARE IN COMPLIANCE WITH

the Italian Decree dated 6th April 2004, n. 174 of the Ministry of Health. Regulation concerning materials and objects intended to be used in fixed systems for the collection, treatment, adduction and distribution of water for human consumption (G.U. n. 166 dated 17-7-2004)

The conformity test has been realized by ICIM on the basis of the above.

It's responsibility of the user to check the eventual suitability of the products for the usage at the specific conditions of use. Tierre Group S.p.a. recommends to do a washing cycle of the circuit realized using the products object of this declaration before starting the system.

This declaration doesn't give any indication regarding the usability from a technical and a technological point of view. It's responsibility of the user to check the suitability of the material for the application. At the same time it's responsibility of the industrial and the commercial operators to maintain the traceability of the products supplied by Tierre Group S.p.a.

All the supporting documents relating to this declaration, including those referring to the tests realized on the products and demonstrating the conformity of the products themselves, are available to be checked by the competent authorities, when asked, at the Tierre Group S.p.a. headquarters.

This declaration is valid starting from the date below mentioned and will be replaced if some substantial changes are introduced, such as modifications in the production of materials changing the essential requirements in compliance with the conformity or modifications and updates in the legislative references mentioned in this declaration. In these cases a new audit will be required in accordance with the conformity.

Cornano, 15th December 2022

TIERRE GROUP S.p.a.
 Dott. Marco Regis



M2DC rev.0 Gennaio 2020

ICIM Produkt-Zertifizierung: Materialien mit Lebensmittelkontakt

Il presente documento annulla e sostituisce il certificato di pari numero emesso in data 13/05/2021.			
	PRD N° 004 B	Certificazione di Prodotto <i>Product Certification</i>	
	Certificato N. ICIM-MOC-009809-00 Certificate No.		
	ALL'AZIENDA / TO THE FIRM		
	TIERRE GROUP S.P.A. VIA DELL'INDUSTRIA, 18 20032 CORMANO MI IT - Italia		
	PER I SEGUENTI PRODOTTI / FOR THE FOLLOWING PRODUCTS		
	Raccordi ad innesto rapido in acciaio inox AISI 316L. Raccordi ad innesto rapido in ottone con trattamento T.E.A. Raccordi ad innesto rapido in ottone CW510L <i>AISI 316L stainless steel push-in fittings.</i> <i>Brass push-in fittings with T.E.A. plating</i> <i>CW510L Brass push-in fittings</i>		
	CON DENOMINAZIONE COMMERCIALE / WITH TRADE NAME/S		
	Serie XVR INOX AISI 316L / XVR SERIES INOX AISI 316L Food grade serie HFR/ Food grade HFR SERIES Serie LFR(P) / LFR(P) Series Serie HLFR (P) / HLFR(P) Series		
	CONFORMEMENTE AL DOCUMENTO NORMATIVO ICIM / IN COMPLIANCE WITH ICIM NORMATIVE DOCUMENT		
0445CS PRODOTTI E COMPONENTI A CONTATTO CON ALIMENTI SECONDO DISPOSIZIONI MOCA <i>PRODUCTS AND COMPONENTS IN CONTACT WITH FOOD ACCORDING TO FCM REGULATIONS</i>			
 Vincenzo Delacqua Rappresentante Direzione / Management Representative ICIM S.p.A.			
PRIMA EMISSIONE <i>FIRST ISSUE</i> 13/02/2020	EMISSIONE CORRENTE <i>CURRENT ISSUE</i> 09/11/2022	DATA DI SCADENZA <i>EXPIRING DATE</i> 12/02/2025	
ICIM S.p.A. - Piazza Don Enrico Mapelli, 75 - 20099 Sesto San Giovanni (MI) Società soggetta all'attività di direzione e coordinamento di ICIM GROUP Srl			

0549CM_00_IT



ICIM Produkt-Zertifizierung: Materialien mit Wasserkontakt

Il presente documento annulla e sostituisce il certificato di pari numero emesso in data 13/02/2020.						
	PRD N° 004 B Membro degli Accordi di Mutuo Riconoscimento EA, IAF e ILAC Signatory of EA, IAF and ILAC Mutual Recognition Agreements					
						
	<h2 style="text-align: center;">Certificazione di Prodotto</h2> <h3 style="text-align: center;">Product Certification</h3>					
	Certificato N. ICIM-CAP-009810-00 Certificate No.					
	ALL'AZIENDA / TO THE FIRM <h3 style="text-align: center;">TIERRE GROUP S.P.A.</h3> Via dell'Industria, 18 – 20032 Cormano (MI) Italia					
	UNITÀ OPERATIVE / OPERATIVE UNITS Via dell'Industria, 18 – 20032 Cormano (MI) Italia					
	PER I SEGUENTI PRODOTTI / FOR THE FOLLOWING PRODUCTS Raccordi ad innesto rapido in acciaio inox AISI 316L. Raccordi ad innesto rapido in ottone CW510L. <i>AISI 316L stainless steel push-in fittings.</i> <i>CW510L Brass push-in fittings.</i>					
	CON DENOMINAZIONE COMMERCIALE / WITH TRADE NAME/S Serie XVR INOX AISI 316L / XVR SERIES INOX AISI 316L Serie LFR(P) / LFR(P) Series					
	CONFORMEMENTE AL DOCUMENTO NORMATIVO ICIM / IN COMPLIANCE WITH ICIM NORMATIVE DOCUMENT <h3 style="text-align: center;">0415CS</h3> Prodotti e componenti utilizzati a contatto con acqua destinata al consumo umano (acqua potabile) sulla base di riferimento delle indicazioni del DM n. 174/2004. Products and components in contact with water intended for human consumption (drinking water) on the basis of the indications of Ministerial Decree nr. 174/2004					
<div style="text-align: center;">  Vincenzo Delacqua Rappresentante Direzione / Management Representative </div>						
<div style="text-align: center;"> ICIM S.p.A. </div>						
<table border="1" style="width: 100%; border-collapse: collapse;"> <thead> <tr> <th style="text-align: left;">PRIMA EMISSIONE FIRST ISSUE</th> <th style="text-align: left;">EMISSIONE CORRENTE CURRENT ISSUE</th> <th style="text-align: left;">DATA DI SCADENZA EXPIRING DATE</th> </tr> </thead> <tbody> <tr> <td style="text-align: center;">13/02/2020</td> <td style="text-align: center;">13/05/2021</td> <td style="text-align: center;">12/02/2025</td> </tr> </tbody> </table>	PRIMA EMISSIONE FIRST ISSUE	EMISSIONE CORRENTE CURRENT ISSUE	DATA DI SCADENZA EXPIRING DATE	13/02/2020	13/05/2021	12/02/2025
PRIMA EMISSIONE FIRST ISSUE	EMISSIONE CORRENTE CURRENT ISSUE	DATA DI SCADENZA EXPIRING DATE				
13/02/2020	13/05/2021	12/02/2025				
ICIM S.p.A. - Piazza Don Enrico Mapelli, 76 - 20099 Gesto San Giovanni (MI)						



Tierre Group S.p.a.

via dell'Industria, 18 - 20032 Cormano (MI)

Tel. +39 02 663088.1 - Fax +39 02 66304172

www.tierregroup.com - info@tierregroup.com



Wassertechnik PRO

Queerenring 10B

D-04626 Schmölln

Telefon: +49 (0)3 44 91 - 58 16 11

Mobil: +49 (0)151 - 67 11 55 90

post@wassertechnik.pro

www.wassertechnik.pro